



LEAD IN POTABLE WATER SCREENING REPORT

INVESTIGATION FOR: Kenneth Stromsland
Board of Education Township of Edison
312 Pierson Avenue
Edison, NJ 07642

SITE INVESTIGATED: Woodrow Wilson Middle
50 Woodrow Wilson Drive
Edison, NJ 08820

ASSESSMENT BY: Kyle Brown
Omega Environmental Services, Inc.
280 Huyler Street
South Hackensack, NJ 07606

**INVESTIGATION
CONDUCTED:** 8/12/16

DATE OF REPORT: 9/9/16

(Omega Project # 16-27002O)

TABLE OF CONTENTS

EXECUTIVE SUMMARY/PROJECT OVERVIEW

- 1. RESULTS TABLE**
- 2. SAMPLING METHODOLOGY**
- 3. DISCUSSION OF RESULTS**
- 4. RECOMMENDATIONS**

Appendices:

- A. Outlet Location Plan/Outlet Inventory
- B. Laboratory Analytical Reports

EXECUTIVE SUMMARY:

The Board of Education Township of Edison requested lead in water testing of potable water outlets at Woodrow Wilson Middle, 50 Woodrow Wilson Drive, Edison, NJ 08820.

Previous Testing

No information related to previous testing was available.

Recent Testing (8/12/16)

In order to assess the building water outlets a full testing of all potable outlets was performed on August 12, 2016.

Reportedly the outlets were not flushed or used on the day of testing.

First draw and flush samples (30 second) were collected of 30 water fountains and sinks.

Results of most first draw samples analyzed were below the Lead and Copper Rule action level of 15 ppb. One first draw sample was above 15 ppb. The associated flush sample was below 15 ppb.

See Section 3 Discussion of Results

1 RESULTS TABLE:

Sample #	Location	1 st draw (FD) or flush (FL)	Results (ppb)	LCR Action Level ⁽¹⁾ (ppb)
1	Water Fountain in Cafeteria	FD	<1.0	15
2	Water Fountain in Cafeteria	FL	<1.0	15
3	Kitchen Sink Dishwashing Area (L)	FD	2.4	15
4	Kitchen Sink Dishwashing Area (L)	FL	<1.0	15
5	Kitchen Sink Dishwashing Area (R)	FD	1.2	15
6	Kitchen Sink Dishwashing Area (R)	FL	<1.0	15
7	Kitchen Sink across grill	FD	1.9	15
8	Kitchen Sink across grill	FL	<1.0	15
9	Kitchen Sink across oven	FD	2.7	15
10	Kitchen Sink across oven	FL	<1.0	15
11	Kitchen Sink Hand washing station	FD	1.8	15
12	Kitchen Sink Hand washing station	FL	<1.0	15
13	Room 117 1 st Sink to left	FD	2.9	15
14	Room 117 1 st Sink to left	FL	<1.0	15
15	Room 117 2 nd Sink on left wall	FD	3.0	15
16	Room 117 2 nd Sink on left wall	FL	<1.0	15
17	Room 117 Back left Sink	FD	14	15
18	Room 117 Back left Sink	FL	<1.0	15
19	Room 117 Back right Sink	FD	5.1	15
20	Room 117 Back right Sink	FL	<1.0	15
21	Room 117 Front right Sink	FD	5.9	15
22	Room 117 Front right Sink	FL	<1.0	15
23	Water Fountain near Nurse's Office (L)	FD	7.2	15
24	Water Fountain near Nurse's Office (L)	FL	1.3	15
25	Water Fountain near Nurse's Office (C)	FD	2.5	15
26	Water Fountain near Nurse's Office (C)	FL	<1.0	15
27	Water Fountain near Nurse's Office (R)	FD	2.7	15
28	Water Fountain near Nurse's Office (R)	FL	<1.0	15
29	Sink in Nurse's Office	FD	1.4	15
30	Sink in Nurse's Office	FL	<1.0	15
31	Main Office Sink	FD	<1.0	15
32	Main Office Sink	FL	<1.0	15
33	Faculty Room Sink	FD	<1.0	15
34	Faculty Room Sink	FL	<1.0	15
35	Water Fountain across 110 (L)	FD	<1.0	15
36	Water Fountain across 110 (L)	FL	<1.0	15
37	Water Fountain across 110 (C)	FD	1.6	15
38	Water Fountain across 110 (C)	FL	<1.0	15
39	Water Fountain across 110 (R)	FD	<1.0	15
40	Water Fountain across 110 (R)	FL	<1.0	15

41	Water Fountain 6 th Grade Hallway (L)	FD	<1.0	15
42	Water Fountain 6 th Grade Hallway (L)	FL	<1.0	15
43	Water Fountain 6 th Grade Hallway (R)	FD	<1.0	15
44	Water Fountain 6 th Grade Hallway (R)	FL	<1.0	15
45	Library Sink	FD	19	15
46	Library Sink	FL	1.9	15
47	Water Fountain across 214 (farthest left)	FD	<1.0	15
48	Water Fountain across 214 (farthest left)	FL	<1.0	15
49	Water Fountain across 214 (2 nd farthest left)	FD	1.3	15
50	Water Fountain across 214 (2 nd farthest left)	FL	<1.0	15
51	Water Fountain across 214 (2 nd farthest right)	FD	1.1	15
52	Water Fountain across 214 (2 nd farthest right)	FL	<1.0	15
53	Water Fountain across 214 (farthest right)	FD	<1.0	15
54	Water Fountain across 214 (farthest right)	FL	<1.0	15
55	Sink in Room 216 (prep)	FD	2.9	15
56	Sink in Room 216 (prep)	FL	<1.0	15
57	Prep Sink in Room 220	FD	2.3	15
58	Prep Sink in Room 220	FL	<1.0	15
59	Prep Sink in Room 223	FD	2.5	15
60	Prep Sink in Room 223	FL	<1.0	15

⁽¹⁾ EPA Lead in Copper Rule (1991) Action Level for water suppliers (municipalities and private wells) and March 2016 Newark Public Schools Lead Water Testing Sampling Plan.

FD – First Draw Sample

FL – Flush Sample (30 sec)

NA – Not Analyzed

2 SAMPLING METHODOLOGY:

First Draw Samples - Without allowing any water to spill until sample collection, samples were collected with a relatively slow flow rate in 250 mL bottles prepared with Nitric Acid (HNO₃) as a preservative.

Flush Samples – After collection of first draw samples the water was allowed to flow at a relatively slow rate for thirty second to flush the fixture and close piping. The flush samples are intended to test the plumbing further upstream from the fixture (behind walls).

The samples were packaged in a cooler and shipped to Pace Analytical, Melville, NY for total lead in potable water analysis (method E200.8 IOC).

3 DISCUSSION OF RESULTS:

One first draw sample results were above 15 ppb, but associated flush sample result was below 15 ppb. This indicates the source of lead is related to the fixtures themselves, not in the main building plumbing.

4 RECOMMENDATIONS:

Short term:

- Take the one outlet with elevated results out of service.
- Conduct further evaluation and testing of the one outlet with elevated results.
- If the one outlet with elevated results has an aerator, remove the aerator and re-test. Ensure that proper pre-sampling procedures are followed if the outlet has not been used for more than a few days.

Long Term:

- If additional testing shows similar results (first draw results above 15 ppb) consider replacing the spout of the fountains (may contain brass, adding to lead levels), installing filters (if practical), or fixture replacement.
- Repeat full building testing on an annual basis. Generally this should be performed in August prior to the start of the school season.
- Develop a Lead in Water Management Plan in accordance with the 2006 EPA 3Ts for Reducing Lead in Drinking Water in Schools.

A. Outlet Location Plan/Outlet Inventory

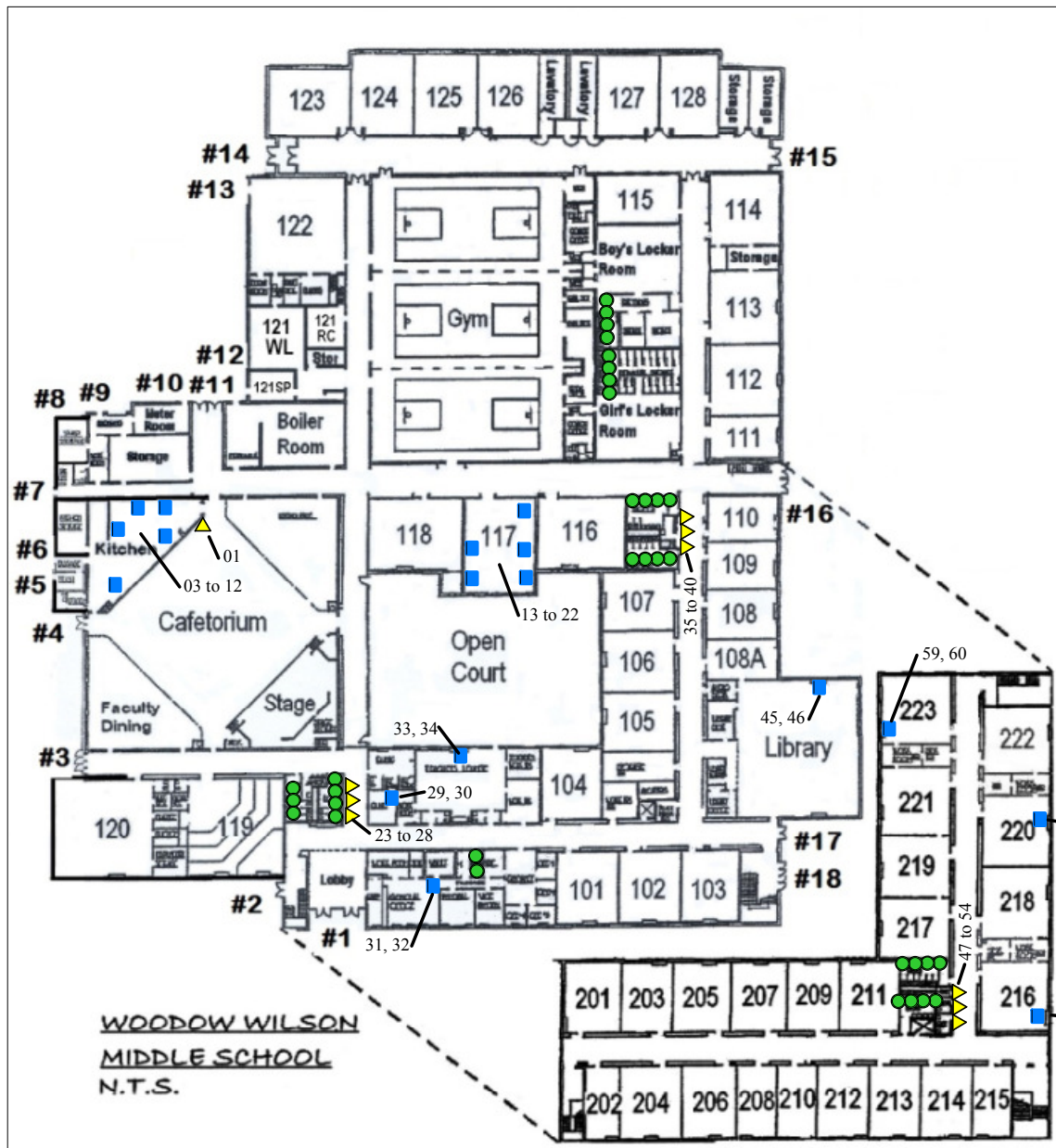

NOTES:

1. Outlets shown may not represent all building outlets, only those sampled on 8/19/16.
2. Sample number shown are not outlet numbers.
3. Outlet locations are approximate.

KEY

- KC = Kitchen Outlet, Cold
- ▲ WC = Water Cooler (Chilled Bubbler Unit)
- TL= Teacher Lounge Sink
- FP= Food Preparation Sink
- ▲ DW= Drinking Water Bubbler (non-chilled)
- SDW= Combination Sink Water Bubbler
- ▲ DDW=Double Drinking Water Bubbler
- LS=Laboratory Sink
- EC = Home Economics Outlet, Cold
- IM = Ice Machine
- BS = Bathroom Sink
- NS = Nurse's Office Sink
- SS=Janitors Slop Sink
- /A = outlet has an aerator
- /F = outlet has a filter
- 01=Sample #

Dwg. Title: Sample Plan

Location: Woodrow Wilson Middle School, Edison, NJ

Client: Edison Township Board of Education

OMEGA
ENVIRONMENTAL
SERVICES, INC.

280 Huyler Street
S. Hackensack, NJ 07606
Tel: (201) 489-8700
Fax: (201) 342-5412

Date: 8/31/16

Proj. # 16-270020

Dwn. By: DSE

Dwg. # 270020-01P

B. Lead in Water Laboratory Reports

CHAIN-OF-CUSTODY / Analytical Request Document

The Chain-of-Custody is a LEGAL DOCUMENT. All relevant fields must be completed accurately.

Section A Client Information: Company: Omega Environmental Address: 280 Huyler Street S. Hackensack, NJ 07606 Phone: 201-489-8700 Fax: _____ Email: Lab@Omega-env.com Project Name: <u>Warden Wilson Middle</u> Project Number: <u>16-27020</u>		Section B Required Project Information: Report To: Lab@omega-env.com Copy To: mikel@omega-env.com, davide@omega-env.com emmam@omega-env.com Purchase Order No.: _____ Project Name: <u>Warden Wilson Middle</u> Project Number: <u>16-27020</u>		Section C Invoice Information: Attention: Accts Payable Company Name: Omega Environmental Address: 280 Huyler St, S Hackensack, NJ Pace Quote Reference: _____ Pace Project Manager: _____ Pace Profile #: _____		Page: <u>1</u> of <u>5</u>	
REGULATORY AGENCY <input type="checkbox"/> NPDES <input type="checkbox"/> GROUND WATER <input checked="" type="checkbox"/> DRINKING WATER <input type="checkbox"/> UST <input type="checkbox"/> RCRA <input type="checkbox"/> OTHER _____		Site Location STATE: <u>NJ</u>					
Section D Required Client Information Valid Matrix Codes MATRIX CODE DRINKING WATER DW WASTE WATER WW WASTE WATER PRODUCT P WASTE WATER SOLID S OIL OIL WASTE WASTE WP AIR AIR TISSUE TISSUE TS		SAMPLE ID (A-Z, 0-9 / -) Sample IDs MUST BE UNIQUE		Pace Project No./ Lab I.D. <u>1608387</u>			
ADDITIONAL COMMENTS 1. PD 2. FL First Draw Sample Flush Sample		RELINQUISHED BY / AFFILIATION DATE <u>8/19/16</u> 11:45 <u>Thom D'Amico</u>		ACCEPTED BY / AFFILIATION DATE <u>8/19/16</u> 9:30 <u>Thom D'Amico</u>			
SAMPLE TEMP AT COLLECTION DATE <u>8/19/16</u> 6:00		# OF CONTAINERS DATE <u>8/19/16</u> 11:45		SAMPLE CONDITIONS Temp in °C Received on Custody Sealed Cooler Samples Intact			
MATRIX CODE (see valid codes to left) SAMPLE TYPE (G=GRAB C=COMP) COLLECTED COMPOSITE START COMPOSITE END/GRAB DATE TIME DATE TIME		PRESERVATIVES Unpreserved H ₂ SO ₄ HNO ₃ HCl NaOH Na ₂ S ₂ O ₃ Methanol Other		Requested Analysis Filtered (Y/N) Lead in drink water 200.8 Residual Chlorine (Y/N)			

[illegible]

Section A Required Client Information:		Section B Required Project Information:		Section C Invoice Information:	
Company:	Omega Environmental	Report To:	Lab@omega-env.com	Attention:	Accts Payable
Address:	280 Huyler Street	Copy To:	mikel@omega-env.com, davide@omega-env.com	Company Name:	Omega Environmental
	S. Hackensack, NJ 07606		emmam@omega-env.com	Address:	280 Huyler St, S Hackensack, NJ
Email To:	Lab@Omega-env.com	Purchase Order No.:		Pace Quote Reference:	
Phone:	201-489-8700	Project Name:	Woodsen Wilson Middle	Pace Project Manager:	
Requested Due Date/TAT:	5 day	Project Number:	16-22020	Pace Profile #:	

REGULATORY AGENCY

☐ NPDES ☐ GROUND WATER ☒ DRINKING WATER

☐ UST ☐ RCRA ☐ OTHER

Site Location: **NJ**

STATE: **NJ**

ITEM #	Section D Required Client Information		Valid Matrix Codes		MATRIX CODE (see valid codes to left)	SAMPLE TYPE (G=GRAB C=COMP)	COLLECTED			SAMPLE TEMP AT COLLECTION	# OF CONTAINERS	Preservatives										Y/N	Requested Analysis Filtered (Y/N)										Pace Project No./ Lab I.D.																																																																																																																																																																																																																																																																																																																																																																																																																																																																																																																																																																																																																																																																																																																																																																																																																																																																																																																																																																																																																																																																																																																																																																																																																																																																																																									
	Required Client Information	Valid Matrix Codes	MATRIX CODE	DRINKING WATER			DW	WASTE WATER	WT			WASTE WATER PRODUCT	WW	SOIL/SOLID	P	SL	OL	WP	AR	OT	TS		Unpreserved	H ₂ SO ₄	HNO ₃	HCl	NaOH	Na ₂ S ₂ O ₃	Methanol	Other	Analysis Test	Lead in drink water 200.8		Residual Chlorine (Y/N)																																																																																																																																																																																																																																																																																																																																																																																																																																																																																																																																																																																																																																																																																																																																																																																																																																																																																																																																																																																																																																																																																																																																																																																																																																																																																																								
1	19A - WF across 110 (C)	↓	DW	G																																																																																																																																																																																																																																																																																																																																																																																																																																																																																																																																																																																																																																																																																																																																																																																																																																																																																																																																																																																																																																																																																																																																																																																																																																																																																																																																						</

ADDITIONAL COMMENTS

FD - First Draw Sample

FL - Flush Sample

RELINQUISHED BY / AFFILIATION: *Thomson* DATE: 8/19/16 TIME: 11:45

ACCEPTED BY / AFFILIATION: *Thomson* DATE: 8/19/16 TIME: 9:30

SAMPLE CONDITIONS

Temp in °C: _____ Received on: _____ Ice (Y/N): _____ Custody Sealed Cooler (Y/N): _____ Samples Intact (Y/N): _____

SAMPLER NAME AND SIGNATURE

PRINT Name of SAMPLER: *Kyle Beem*

SIGNATURE of SAMPLER: *Kyle Beem*

DATE Signed (MM/DD/YY): 08/12/16

CHAIN-OF-CUSTODY / Analytical Request Document

The Chain-of-Custody is a LEGAL DOCUMENT. All relevant fields must be completed accurately.

Page: 5 of 5

Section A Required Client Information:		Section B Required Project Information:		Section C Invoice Information:	
Company:	Omega Environmental	Report To:	Lab@omega-env.com	Attention:	Accts Payable
Address:	280 Huyler Street S. Hackensack, NJ 07606	Copy To:	mikel@omega-env.com, davide@omega-env.com	Company Name:	Omega Environmental
Email To:	Lab@Omega-env.com	Purchase Order No.:		Address:	280 Huyler St, S Hackensack, NJ
Phone:	201-489-8700	Project Name:	Wilson Wilson Amble	Pace Quote Reference:	
Requested Due Date/TAT:	5 day	Project Number:	16-270020	Pace Project Manager:	

ITEM #	Valid Matrix Codes MATRIX CODE DRINKING WATER DW WASTE WATER WW PRODUCT P SOLID S OIL OIL WIFE WIFE AIR AIR OTHER OT TISSUE TS	COLLECTED		SAMPLE TYPE (G=GRAB C=COMP)	MATRIX CODE (see valid codes to left)	# OF CONTAINERS	Preservatives										Analysis Test ↑	Lead in drink water 200.8	Requested Analysis Filtered (Y/N)	Pace Project No./ Lab I.D.
		COMPOSITE START	COMPOSITE END/GRAB				DATE	TIME	H ₂ SO ₄	HNO ₃	HCl	NaOH	Na ₂ SO ₄	Methanol	Other					
1	25A - W F access 24 2nd Hackensack				DW	G														
2	25B - ↓				DW	G														
3	26A - W F access 24 2nd Hackensack				DW	G														
4	26B - ↓				DW	G														
5	27A - W F access 24 2nd Hackensack Right				DW	G														
6	27B - ↓				DW	G														
7	28A - Sink in Rm 216 (P100)				DW	G														
8	28B - ↓				DW	G														
9	29A - 910 sink in Rm 220				DW	G														
10	29B - ↓				DW	G														
11	30A - 910 sink in Rm 223				DW	G														
12	30B - ↓				DW	G														

ADDITIONAL COMMENTS	RELINQUISHED BY / AFFILIATION		ACCEPTED BY / AFFILIATION		SAMPLE CONDITIONS	
	DATE	TIME	DATE	TIME	Temp in °C	Samples Intact (Y/N)
FD - First Draw Sample	8/19/16	11:45	8/19/16	9:30		
FL - Flush Sample	8/19/16	11:45	8/19/16	11:45		

SAMPLER NAME AND SIGNATURE	
PRINT Name of SAMPLER:	DATE Signed (MM/DD/YYYY):
SIGNATURE of SAMPLER:	



LABORATORY RESULTS

Results for the samples and analytes requested

The lab is not directly responsible for the integrity of the sample before receipt at the lab and is responsible only for the certified tests requested.

Omega Environmental Services

280 Huyler Street

South Hackensack, NJ 07606

Attn To : Michael Levay

Federal ID :

Copies To :

Received : 08/19/16 11:45 AM

Collected By : Client

Sample Type : Potable Water

CC

Date Reported : 8/29/2016

Lab Number	Location	Collected	<u>Lead</u>	
			<u>Units</u>	
			<u>Method</u>	
			<u>Limits</u>	
1608J87-001A	01A- WF IN CAFETERIA	8/12/2016 6:00:00 AM	ug/L	E200.8 : IOC
			15	
			Analysis	< 1.0
			Time	8/26/2016 5:17:13 PM
Distribution				WOODROW WILSON MIDDLE
1608J87-002A	01B- WF IN CAFETERIA	8/12/2016 6:00:00 AM	Analysis	< 1.0
			Time	8/26/2016 5:20:08 PM
Distribution				WOODROW WILSON MIDDLE
1608J87-003A	02A- KS DISHWASHING A	8/12/2016 6:00:00 AM	Analysis	2.4
			Time	8/26/2016 5:23:03 PM
Distribution				WOODROW WILSON MIDDLE
1608J87-004A	02B- KS DISHWASHING A	8/12/2016 6:00:00 AM	Analysis	< 1.0
			Time	8/26/2016 5:25:58 PM
Distribution				WOODROW WILSON MIDDLE
1608J87-005A	03A- KS DISHWASHING A	8/12/2016 6:00:00 AM	Analysis	1.2
			Time	8/26/2016 5:28:54 PM
Distribution				WOODROW WILSON MIDDLE

Result(s) reported meet(s) NYS Regulatory Limit(s).

Result(s) flagged with * Exceed NYS Regulatory Limit(s). Limit noted.

+ = ELAP / NELAC does not offer certification for this analyte

Treatments:

A = Air Stripper Tower G = Granular Activated Carbon
 FM = Iron/Manganese Removal
 N = Nitrate Removal O = Other

Test results meet the requirements of NELAC unless otherwise noted.

This report shall not be reproduced except in full, without the written approval of the laboratory.

Elizabeth Harrison

Project Manager



LABORATORY RESULTS

Results for the samples and analytes requested

The lab is not directly responsible for the integrity of the sample before receipt at the lab and is responsible only for the certified tests requested.

Omega Environmental Services

280 Huyler Street

South Hackensack, NJ 07606

Attn To : Michael Levay

Federal ID :

Copies To :

Received : 08/19/16 11:45 AM

Collected By : Client

Sample Type : Potable Water

CC

Date Reported : 8/29/2016

Lab Number	Location	Collected	<u>Lead</u>	
			<u>Units</u>	
			<u>Method</u>	
			<u>Limits</u>	
1608J87-006A	03B- KS DISHWASHING A	8/12/2016 6:00:00 AM	ug/L	E200.8 : IOC
			15	
			Analysis	< 1.0
			Time	8/26/2016 5:31:48 PM
Distribution				WOODROW WILSON MIDDLE
1608J87-007A	04A- KS ACROSS GRILL	8/12/2016 6:00:00 AM	1.9	
			Analysis	8/26/2016 5:34:46 PM
			Time	
Distribution				WOODROW WILSON MIDDLE
1608J87-008A	04B- KS ACROSS GRILL	8/12/2016 6:00:00 AM	< 1.0	
			Analysis	8/26/2016 5:37:41 PM
			Time	
Distribution				WOODROW WILSON MIDDLE
1608J87-009A	05A- KS ACROSS OVEN	8/12/2016 6:00:00 AM	2.7	
			Analysis	8/26/2016 5:52:20 PM
			Time	
Distribution				WOODROW WILSON MIDDLE
1608J87-010A	05B- KS ACROSS OVEN	8/12/2016 6:00:00 AM	< 1.0	
			Analysis	8/26/2016 5:55:16 PM
			Time	
Distribution				WOODROW WILSON MIDDLE

Result(s) reported meet(s) NYS Regulatory Limit(s).

Result(s) flagged with * Exceed NYS Regulatory Limit(s). Limit noted.

+ = ELAP / NELAC does not offer certification for this analyte

Treatments:

A = Air Stripper Tower G = Granular Activated Carbon
 FM = Iron/Manganese Removal
 N = Nitrate Removal O = Other

Test results meet the requirements of NELAC unless otherwise noted.

This report shall not be reproduced except in full, without the written approval of the laboratory.

Elizabeth Harrison

Project Manager



LABORATORY RESULTS

Results for the samples and analytes requested

The lab is not directly responsible for the integrity of the sample before receipt at the lab and is responsible only for the certified tests requested.

Omega Environmental Services

280 Huyler Street

South Hackensack, NJ 07606

Attn To : Michael Levay

Federal ID :

Copies To :

Received : 08/19/16 11:45 AM

Collected By : Client

Sample Type : Potable Water

CC

Date Reported : 8/29/2016

Lab Number	Location	Collected	<u>Lead</u>	
			<u>Units</u>	
			<u>Method</u>	
			<u>Limits</u>	
1608J87-011A	06A- KS HANDWASHING	8/12/2016 6:00:00 AM	ug/L	E200.8 : IOC
			15	
			1.8	
			8/26/2016 5:58:12 PM	
Distribution			WOODROW WILSON MIDDLE	
1608J87-012A	06B- KS HANDWASHING	8/12/2016 6:00:00 AM	< 1.0	
			8/26/2016 6:01:06 PM	
Distribution			WOODROW WILSON MIDDLE	
1608J87-013A	07A- RM 117 1ST SINK TO	8/12/2016 6:00:00 AM	2.9	
			8/26/2016 6:04:02 PM	
Distribution			WOODROW WILSON MIDDLE	
1608J87-014A	07B- RM 117 1ST SINK TO	8/12/2016 6:00:00 AM	< 1.0	
			8/26/2016 6:06:57 PM	
Distribution			WOODROW WILSON MIDDLE	
1608J87-015A	08A- RM 117 2ND SINK O	8/12/2016 6:00:00 AM	3.0	
			8/26/2016 6:09:52 PM	
Distribution			WOODROW WILSON MIDDLE	

Result(s) reported meet(s) NYS Regulatory Limit(s).

Result(s) flagged with * Exceed NYS Regulatory Limit(s). Limit noted.

+ = ELAP / NELAC does not offer certification for this analyte

Treatments:

A = Air Stripper Tower G = Granular Activated Carbon
 FM = Iron/Manganese Removal
 N = Nitrate Removal O = Other

Test results meet the requirements of NELAC unless otherwise noted.

This report shall not be reproduced except in full, without the written approval of the laboratory.

Elizabeth Harrison

Project Manager



LABORATORY RESULTS

Results for the samples and analytes requested

The lab is not directly responsible for the integrity of the sample before receipt at the lab and is responsible only for the certified tests requested.

Omega Environmental Services

280 Huyler Street

South Hackensack, NJ 07606

Attn To : Michael Levay

Federal ID :

Copies To :

Received : 08/19/16 11:45 AM

Collected By : Client

Sample Type : Potable Water

CC

Date Reported : 8/29/2016

Lab Number	Location	Collected	<u>Lead</u>	
			<u>Units</u>	
			<u>Method</u>	
			<u>Limits</u>	
1608J87-016A	08B- RM 117 2ND SINK O	8/12/2016 6:00:00 AM	ug/L	E200.8 : IOC
			15	
			Analysis	< 1.0
			Time	8/26/2016 6:12:46 PM
Distribution				WOODROW WILSON MIDDLE
1608J87-017A	09A- RM 117 BACK LEFT	8/12/2016 6:00:00 AM	14	
			Analysis	8/26/2016 6:27:25 PM
			Time	
Distribution				WOODROW WILSON MIDDLE
1608J87-018A	09B- RM 117 BACK LEFT	8/12/2016 6:00:00 AM	< 1.0	
			Analysis	8/26/2016 6:30:20 PM
			Time	
Distribution				WOODROW WILSON MIDDLE
1608J87-019A	10A- RM 117 BACK RIGHT	8/12/2016 6:00:00 AM	5.1	
			Analysis	8/26/2016 6:33:16 PM
			Time	
Distribution				WOODROW WILSON MIDDLE
1608J87-020A	10B- RM 117 BACK RIGHT	8/12/2016 6:00:00 AM	< 1.0	
			Analysis	8/26/2016 6:36:12 PM
			Time	
Distribution				WOODROW WILSON MIDDLE

Result(s) reported meet(s) NYS Regulatory Limit(s).

Result(s) flagged with * Exceed NYS Regulatory Limit(s). Limit noted.

+ = ELAP / NELAC does not offer certification for this analyte

Treatments:

A = Air Stripper Tower G = Granular Activated Carbon
 FM = Iron/Manganese Removal
 N = Nitrate Removal O = Other

Test results meet the requirements of NELAC unless otherwise noted.

This report shall not be reproduced except in full, without the written approval of the laboratory.

Elizabeth Harrison

Project Manager



LABORATORY RESULTS

Results for the samples and analytes requested

The lab is not directly responsible for the integrity of the sample before receipt at the lab and is responsible only for the certified tests requested.

Omega Environmental Services

280 Huyler Street

South Hackensack, NJ 07606

Attn To : Michael Levay

Federal ID :

Copies To :

Received : 08/19/16 11:45 AM

Collected By : Client

Sample Type : Potable Water

CC

Date Reported : 8/29/2016

Lab Number	Location	Collected	<u>Lead</u>	
			<u>Units</u>	
			<u>Method</u>	
			<u>Limits</u>	
			ug/L	
			E200.8 : IOC	
			15	
1608J87-021A	11A- RM 117 FRONT RIG	8/12/2016 6:00:00 AM	Analysis	5.9
			Time	8/26/2016 6:39:07 PM
Distribution				WOODROW WILSON MIDDLE
1608J87-022A	11B- RM 117 FRONT RIG	8/12/2016 6:00:00 AM	Analysis	< 1.0
			Time	8/26/2016 6:42:02 PM
Distribution				WOODROW WILSON MIDDLE
1608J87-023A	12A- WF NEAR NURSES	8/12/2016 6:00:00 AM	Analysis	7.2
			Time	8/26/2016 6:44:58 PM
Distribution				WOODROW WILSON MIDDLE
1608J87-024A	12B- WF NEAR NURSES	8/12/2016 6:00:00 AM	Analysis	1.3 PM
			Time	8/26/2016 6:47:54 PM
Distribution				WOODROW WILSON MIDDLE
1608J87-025A	13A- WF NEAR NURSES	8/12/2016 6:00:00 AM	Analysis	2.5
			Time	8/26/2016 7:02:31 PM
Distribution				WOODROW WILSON MIDDLE

Result(s) reported meet(s) NYS Regulatory Limit(s).

Result(s) flagged with * Exceed NYS Regulatory Limit(s). Limit noted.

+ = ELAP / NELAC does not offer certification for this analyte

Treatments:

A = Air Stripper Tower G = Granular Activated Carbon
 FM = Iron/Manganese Removal
 N = Nitrate Removal O = Other

Test results meet the requirements of NELAC unless otherwise noted.

This report shall not be reproduced except in full, without the written approval of the laboratory.

Elizabeth Harrison

Project Manager



LABORATORY RESULTS

Results for the samples and analytes requested

The lab is not directly responsible for the integrity of the sample before receipt at the lab and is responsible only for the certified tests requested.

Omega Environmental Services

280 Huyler Street

South Hackensack, NJ 07606

Attn To : Michael Levay

Federal ID :

Copies To :

Received : 08/19/16 11:45 AM

Collected By : Client

Sample Type : Potable Water

CC

Date Reported : 8/29/2016

Lab Number	Location	Collected	<u>Lead</u>	
			<u>Units</u>	
			<u>Method</u>	
			<u>Limits</u>	
1608J87-026A	13B- WF NEAR NURSES	8/12/2016 6:00:00 AM	ug/L	E200.8 : IOC
			15	
			Analysis	< 1.0
			Time	8/26/2016 7:05:26 PM
Distribution				WOODROW WILSON MIDDLE
1608J87-027A	14A- WF NEAR NURSES	8/12/2016 6:00:00 AM	2.7	
			Analysis	8/26/2016 7:08:20 PM
			Time	
Distribution				WOODROW WILSON MIDDLE
1608J87-028A	14B- WF NEAR NURSES	8/12/2016 6:00:00 AM	< 1.0	
			Analysis	8/26/2016 7:11:16 PM
			Time	
Distribution				WOODROW WILSON MIDDLE
1608J87-029A	15A- SINK IN NURSES OF	8/12/2016 6:00:00 AM	1.4	
			Analysis	8/26/2016 7:14:12 PM
			Time	
Distribution				WOODROW WILSON MIDDLE
1608J87-030A	15B- SINK IN NURSES OF	8/12/2016 6:00:00 AM	< 1.0	
			Analysis	8/26/2016 7:17:07 PM
			Time	
Distribution				WOODROW WILSON MIDDLE

Result(s) reported meet(s) NYS Regulatory Limit(s).

Result(s) flagged with * Exceed NYS Regulatory Limit(s). Limit noted.

+ = ELAP / NELAC does not offer certification for this analyte

Treatments:

A = Air Stripper Tower G = Granular Activated Carbon
 FM = Iron/Manganese Removal
 N = Nitrate Removal O = Other

Test results meet the requirements of NELAC unless otherwise noted.

This report shall not be reproduced except in full, without the written approval of the laboratory.

Elizabeth Harrison

Project Manager



LABORATORY RESULTS

Results for the samples and analytes requested

The lab is not directly responsible for the integrity of the sample before receipt at the lab and is responsible only for the certified tests requested.

Omega Environmental Services

280 Huyler Street

South Hackensack, NJ 07606

Attn To : Michael Levay

Federal ID :

Copies To :

Received : 08/19/16 11:45 AM

Collected By : Client

Sample Type : Potable Water

CC

Date Reported : 8/29/2016

Lab Number	Location	Collected	<u>Lead</u>	
			<u>Units</u>	
			<u>Method</u>	
			<u>Limits</u>	
			ug/L	
			E200.8 : IOC	
			15	
1608J87-031A	16A- MAIN OFFICE SINK	8/12/2016 6:00:00 AM	Analysis	< 1.0
			Time	8/26/2016 7:20:02 PM
Distribution				WOODROW WILSON MIDDLE
1608J87-032A	16B- MAIN OFFICE SINK	8/12/2016 6:00:00 AM	Analysis	< 1.0
			Time	8/26/2016 7:22:59 PM
Distribution				WOODROW WILSON MIDDLE
1608J87-033A	17A- FACULTY RM SINK	8/12/2016 6:00:00 AM	Analysis	< 1.0
			Time	8/26/2016 7:37:37 PM
Distribution				WOODROW WILSON MIDDLE
1608J87-034A	17B- FACULTY RM SINK	8/12/2016 6:00:00 AM	Analysis	< 1.0
			Time	8/26/2016 7:40:32 PM
Distribution				WOODROW WILSON MIDDLE
1608J87-035A	18A- WF ACROSS 110 (L)	8/12/2016 6:00:00 AM	Analysis	< 1.0
			Time	8/26/2016 7:43:27 PM
Distribution				WOODROW WILSON MIDDLE

Result(s) reported meet(s) NYS Regulatory Limit(s).

Result(s) flagged with * Exceed NYS Regulatory Limit(s). Limit noted.

+ = ELAP / NELAC does not offer certification for this analyte

Treatments:

A = Air Stripper Tower G = Granular Activated Carbon
 FM = Iron/Manganese Removal
 N = Nitrate Removal O = Other

Test results meet the requirements of NELAC unless otherwise noted.

This report shall not be reproduced except in full, without the written approval of the laboratory.

Elizabeth Harrison

Project Manager



LABORATORY RESULTS

Results for the samples and analytes requested

The lab is not directly responsible for the integrity of the sample before receipt at the lab and is responsible only for the certified tests requested.

Omega Environmental Services

280 Huyler Street

South Hackensack, NJ 07606

Attn To : Michael Levay

Federal ID :

Copies To :

Received : 08/19/16 11:45 AM

Collected By : Client

Sample Type : Potable Water

CC

Date Reported : 8/29/2016

Lab Number	Location	Collected	Lead	
			Units	ug/L
			Method	E200.8 : IOC
			Limits	15
1608J87-036A	18B- WF ACROSS 110 (L)	8/12/2016 6:00:00 AM	Analysis	< 1.0
Distribution			Time	8/26/2016 7:46:20 PM
				WOODROW WILSON MIDDLE
1608J87-037A	19A- WF ACROSS 110 (C)	8/12/2016 6:00:00 AM	Analysis	1.6
Distribution			Time	8/26/2016 7:49:16 PM
				WOODROW WILSON MIDDLE
1608J87-038A	19B- WF ACROSS 110 (C)	8/12/2016 6:00:00 AM	Analysis	< 1.0
Distribution			Time	8/26/2016 7:52:10 PM
				WOODROW WILSON MIDDLE
1608J87-039A	20A- WF ACROSS 110 (R)	8/12/2016 6:00:00 AM	Analysis	< 1.0
Distribution			Time	8/26/2016 7:55:06 PM
				WOODROW WILSON MIDDLE
1608J87-040A	20B- WF ACROSS 110 (R)	8/12/2016 6:00:00 AM	Analysis	< 1.0
Distribution			Time	8/26/2016 7:58:00 PM
				WOODROW WILSON MIDDLE

Result(s) reported meet(s) NYS Regulatory Limit(s).

Result(s) flagged with . Exceed NYSRegulatory Limit(s). Limit noted.

+ = ELAP / NELAC does not offer certification for this analyte

Treatments:

A = Air Stripper Tower G = Granular Activated Carbon

FM = Iron/Manganese Removal

N = Nitrate Removal O = Other

Test results meet the requirements of NELAC unless otherwise noted.

Project Manager

This report shall not be reproduced except in full,
without the written approval of the laboratory.

Page 8 of 14



LABORATORY RESULTS

Results for the samples and analytes requested

The lab is not directly responsible for the integrity of the sample before receipt at the lab and is responsible only for the certified tests requested.

Omega Environmental Services

280 Huyler Street

South Hackensack, NJ 07606

Attn To : Michael Levay

Federal ID :

Copies To :

Received : 08/19/16 11:45 AM

Collected By : Client

Sample Type : Potable Water

CC

Date Reported : 8/29/2016

Lab Number	Location	Collected	<u>Lead</u>	
			<u>Units</u>	
			<u>Method</u>	
			<u>Limits</u>	
1608J87-041A	21A- WF ACROSS 6TH G	8/12/2016 6:00:00 AM	ug/L	E200.8 : IOC
			15	
			Analysis	< 1.0
			Time	8/26/2016 8:12:41 PM
Distribution				WOODROW WILSON MIDDLE
1608J87-042A	21B- WF ACROSS 6TH G	8/12/2016 6:00:00 AM	Analysis	< 1.0
			Time	8/26/2016 8:15:35 PM
Distribution				WOODROW WILSON MIDDLE
1608J87-043A	22A- WF 6TH GRADE HAL	8/12/2016 6:00:00 AM	Analysis	< 1.0
			Time	8/26/2016 8:18:28 PM
Distribution				WOODROW WILSON MIDDLE
1608J87-044A	22B- WF 6TH GRADE HAL	8/12/2016 6:00:00 AM	Analysis	< 1.0
			Time	8/26/2016 8:21:23 PM
Distribution				WOODROW WILSON MIDDLE
1608J87-045A	23A- LIBRARY SINK	8/12/2016 6:00:00 AM	Analysis	19 *
			Time	8/26/2016 8:24:17 PM
Distribution				WOODROW WILSON MIDDLE

Result(s) reported meet(s) NYS Regulatory Limit(s).

Result(s) flagged with * Exceed NYS Regulatory Limit(s). Limit noted.

+ = ELAP / NELAC does not offer certification for this analyte

Treatments:

A = Air Stripper Tower G = Granular Activated Carbon
 FM = Iron/Manganese Removal
 N = Nitrate Removal O = Other

Test results meet the requirements of NELAC unless otherwise noted.

This report shall not be reproduced except in full, without the written approval of the laboratory.

Elizabeth Harrison

Project Manager



LABORATORY RESULTS

Results for the samples and analytes requested

The lab is not directly responsible for the integrity of the sample before receipt at the lab and is responsible only for the certified tests requested.

Omega Environmental Services

280 Huyler Street

South Hackensack, NJ 07606

Attn To : Michael Levay

Federal ID :

Copies To :

Received : 08/19/16 11:45 AM

Collected By : Client

Sample Type : Potable Water

CC

Date Reported : 8/29/2016

Lab Number	Location	Collected	<u>Lead</u>	
			<u>Units</u>	
			<u>Method</u>	
			<u>Limits</u>	
1608J87-046A	23B- LIBRARY SINK	8/12/2016 6:00:00 AM	ug/L	E200.8 : IOC
			15	
			1.9	
			8/26/2016 8:27:12 PM	
Distribution			WOODROW WILSON MIDDLE	
1608J87-047A	24A- WF ACROSS 214 FA	8/12/2016 6:00:00 AM	< 1.0	
			8/26/2016 8:30:08 PM	
Distribution			WOODROW WILSON MIDDLE	
1608J87-048A	24B- WF ACROSS 214 FA	8/12/2016 6:00:00 AM	< 1.0	
			8/26/2016 8:33:02 PM	
Distribution			WOODROW WILSON MIDDLE	
1608J87-049A	25A- WF ACROSS 214 2N	8/12/2016 6:00:00 AM	1.3	
			8/26/2016 8:47:39 PM	
Distribution			WOODROW WILSON MIDDLE	
1608J87-050A	25B- WF ACROSS 214 2N	8/12/2016 6:00:00 AM	< 1.0	
			8/26/2016 8:50:35 PM	
Distribution			WOODROW WILSON MIDDLE	

Result(s) reported meet(s) NYS Regulatory Limit(s).

Result(s) flagged with * Exceed NYS Regulatory Limit(s). Limit noted.

+ = ELAP / NELAC does not offer certification for this analyte

Treatments:

A = Air Stripper Tower G = Granular Activated Carbon
 FM = Iron/Manganese Removal
 N = Nitrate Removal O = Other

Test results meet the requirements of NELAC unless otherwise noted.

This report shall not be reproduced except in full, without the written approval of the laboratory.

Elizabeth Harrison

Project Manager



LABORATORY RESULTS

Results for the samples and analytes requested

The lab is not directly responsible for the integrity of the sample before receipt at the lab and is responsible only for the certified tests requested.

Omega Environmental Services

280 Huyler Street

South Hackensack, NJ 07606

Attn To : Michael Levay

Federal ID :

Copies To :

Received : 08/19/16 11:45 AM

Collected By : Client

Sample Type : Potable Water

CC

Date Reported : 8/29/2016

Lab Number	Location	Collected	<u>Lead</u>	
			<u>Units</u>	
			<u>Method</u>	
			<u>Limits</u>	
1608J87-051A	26A- WF ACROSS 214 2N	8/12/2016 6:00:00 AM	ug/L	
			E200.8 : IOC	
			15	
			Analysis	1.1
			Time	8/26/2016 8:53:30 PM
Distribution				WOODROW WILSON MIDDLE
1608J87-052A	26B- WF ACROSS 214 2N	8/12/2016 6:00:00 AM		
			Analysis	< 1.0
			Time	8/26/2016 8:56:26 PM
Distribution				WOODROW WILSON MIDDLE
1608J87-053A	27A- WF ACROSS 219 FA	8/12/2016 6:00:00 AM		
			Analysis	< 1.0
			Time	8/26/2016 8:59:22 PM
Distribution				WOODROW WILSON MIDDLE
1608J87-054A	27B- WF ACROSS 219 FA	8/12/2016 6:00:00 AM		
			Analysis	< 1.0
			Time	8/26/2016 9:02:18 PM
Distribution				WOODROW WILSON MIDDLE
1608J87-055A	28A- SINK IN RM 216 (PR	8/12/2016 6:00:00 AM		
			Analysis	2.9
			Time	8/26/2016 9:05:13 PM
Distribution				WOODROW WILSON MIDDLE

Result(s) reported meet(s) NYS Regulatory Limit(s).

Result(s) flagged with * Exceed NYS Regulatory Limit(s). Limit noted.

+ = ELAP / NELAC does not offer certification for this analyte

Treatments:

A = Air Stripper Tower G = Granular Activated Carbon
 FM = Iron/Manganese Removal
 N = Nitrate Removal O = Other

Test results meet the requirements of NELAC unless otherwise noted.

This report shall not be reproduced except in full, without the written approval of the laboratory.

Elizabeth Harrison

Project Manager



LABORATORY RESULTS

Results for the samples and analytes requested

The lab is not directly responsible for the integrity of the sample before receipt at the lab and is responsible only for the certified tests requested.

Omega Environmental Services

280 Huyler Street

South Hackensack, NJ 07606

Attn To : Michael Levay

Federal ID :

Copies To :

Received : 08/19/16 11:45 AM

Collected By : Client

Sample Type : Potable Water

CC

Date Reported : 8/29/2016

Lab Number	Location	Collected	Lead	
			Units	ug/L
			Method	E200.8 : IOC
			Limits	15
1608J87-056A	28B- SINK IN RM 216 (PR	8/12/2016 6:00:00 AM	Analysis	< 1.0
Distribution			Time	8/26/2016 9:08:09 PM
				WOODROW WILSON MIDDLE
1608J87-057A	29A- PREP SINK IN RM 22	8/12/2016 6:00:00 AM	Analysis	2.3
Distribution			Time	8/26/2016 9:22:47 PM
				WOODROW WILSON MIDDLE
1608J87-058A	29B- PREP SINK IN RM 22	8/12/2016 6:00:00 AM	Analysis	< 1.0
Distribution			Time	8/26/2016 9:25:43 PM
				WOODROW WILSON MIDDLE
1608J87-059A	30A- PREP SINK IN RM 22	8/12/2016 6:00:00 AM	Analysis	2.5
Distribution			Time	8/26/2016 9:28:39 PM
				WOODROW WILSON MIDDLE
1608J87-060A	30B- PREP SINK IN RM 22	8/12/2016 6:00:00 AM	Analysis	< 1.0
Distribution			Time	8/26/2016 9:31:34 PM
				WOODROW WILSON MIDDLE

Result(s) reported meet(s) NYS Regulatory Limit(s).

Result(s) flagged with . Exceed NYSRegulatory Limit(s). Limit noted.

+ = ELAP / NELAC does not offer certification for this analyte

Treatments:

A = Air Stripper Tower G = Granular Activated Carbon
FM = Iron/Manganese Removal
N = Nitrate Removal O = Other

Test results meet the requirements of NELAC unless otherwise noted.

Elizabeth Harrison

Project Manager

This report shall not be reproduced except in full,
without the written approval of the laboratory.



PACE ANALYTICAL
575 Broad Hollow Road
Melville, NY 11747
TEL: (631) 694-3040 FAX: (631) 420-8436
Website: www.pacelabs.com

Sample Receipt Checklist

Client Name **OES**

Date and Time Received: **8/19/2016 11:45:00 AM**

Work Order Number: **1608J87**

RcptNo: **1**

Received by: **Matthew Grasso**

Completed by:

Jaclyn Kuri

Reviewed by:

Completed Date: 8/20/2016 6:41:15 PM

Reviewed Date:

Carrier name: Client

Chain of custody present?	Yes <input checked="" type="checkbox"/>	No <input type="checkbox"/>		
Chain of custody signed when relinquished and received?	Yes <input checked="" type="checkbox"/>	No <input type="checkbox"/>		
Chain of custody agrees with sample labels?	Yes <input checked="" type="checkbox"/>	No <input type="checkbox"/>		
Are matrices correctly identified on Chain of custody?	Yes <input checked="" type="checkbox"/>	No <input type="checkbox"/>		
Is it clear what analyses were requested?	Yes <input checked="" type="checkbox"/>	No <input type="checkbox"/>		
Custody seals intact on sample bottles?	Yes <input type="checkbox"/>	No <input type="checkbox"/>	Not Present	<input checked="" type="checkbox"/>
Samples in proper container/bottle?	Yes <input checked="" type="checkbox"/>	No <input type="checkbox"/>		
Were correct preservatives used and noted?	Yes <input checked="" type="checkbox"/>	No <input type="checkbox"/>	NA	<input type="checkbox"/>
Preservative added to bottles:				
Sample Condition?	Intact <input checked="" type="checkbox"/>	Broken <input type="checkbox"/>	Leaking	<input type="checkbox"/>
Sufficient sample volume for indicated test?	Yes <input checked="" type="checkbox"/>	No <input type="checkbox"/>		
Were container labels complete (ID, Pres, Date)?	Yes <input checked="" type="checkbox"/>	No <input type="checkbox"/>		
All samples received within holding time?	Yes <input checked="" type="checkbox"/>	No <input type="checkbox"/>		
Was an attempt made to cool the samples?	Yes <input checked="" type="checkbox"/>	No <input type="checkbox"/>	NA	<input type="checkbox"/>
All samples received at a temp. of > 0° C to 6.0° C?	Yes <input checked="" type="checkbox"/>	No <input type="checkbox"/>	NA	<input type="checkbox"/>
Response when temperature is outside of range:				
Sample Temp. taken and recorded upon receipt?	Yes <input type="checkbox"/>	No <input checked="" type="checkbox"/>	To	°
Water - Were bubbles absent in VOC vials?	Yes <input type="checkbox"/>	No <input type="checkbox"/>	No Vials	<input checked="" type="checkbox"/>
Water - Was there Chlorine Present?	Yes <input type="checkbox"/>	No <input type="checkbox"/>	NA	<input checked="" type="checkbox"/>
Water - pH acceptable upon receipt?	Yes <input checked="" type="checkbox"/>	No <input type="checkbox"/>	No Water	<input type="checkbox"/>
Are Samples considered acceptable?	Yes <input checked="" type="checkbox"/>	No <input type="checkbox"/>		
Custody Seals present?	Yes <input type="checkbox"/>	No <input checked="" type="checkbox"/>		
Airbill or Sticker?	Air Bill <input type="checkbox"/>	Sticker <input type="checkbox"/>	Not Present	<input checked="" type="checkbox"/>
Airbill No:				

Case Number:

SDG:

SAS:

Any No response should be detailed in the comments section below, if applicable.

Client Contacted? ☐ Yes ☐ No ☒ NA Person Contacted:
Contact Mode: ☐ Phone: ☐ Fax: ☐ Email: ☐ In Person:
Client Instructions:
Date Contacted: Contacted By:
Regarding:
Comments:
CorrectiveAction:

WorkOrder :
1608J87

Certifications

STATE	CERTIFICATION #
NEW YORK	10478
NEW JERSEY	NY158
CONNECTICUT	PH-0435
MARYLAND	208
MASSACHUSETTS	M-NY026
NEW HAMPSHIRE	2987
RHODE ISLAND	LAO00340
PENNSYLVANIA	68-00350